

SONY®



PS3™

PlayStation 3

3D Display

Instruction Manual

CECH-ZED1U

4-400-605-11(1) U

WARNING

To avoid electrical shock, do not open the cabinet. Refer servicing to qualified personnel only.

Precautions

Before using this product, carefully read this manual and retain it for future reference. Read also the instructions for the PlayStation®3 system.

Safety

- Do not use a power cord other than the supplied AC power cord. Do not modify the cord.
- Do not allow liquid or small particles to get into the product. If this happens, stop use and disconnect it from the electrical outlet immediately. Contact SCEA Consumer Services for assistance.
- Never disassemble or modify the product.
- Do not expose the product to dust, smoke or steam.
- Do not expose the product to high temperatures, high humidity or direct sunlight.
- Do not touch the product with wet hands.
- Unplug the AC power cord from the electrical outlet before cleaning or when you do not intend to use the system for an extended period of time.
- Keep this product out of the reach of small children. Small children may swallow small parts or may wrap the cables around themselves, which may inflict injury or cause an accident or a malfunction.

Use and handling

- The LCD screen is made of glass and may crack if subjected to excessive force.
- Pixels that are not lit or are continuously lit may appear in certain locations on the LCD screen. The appearance of such spots is a normal occurrence associated with LCD screens and is not a sign of a system malfunction. LCD screens are made using highly precise technology. However, a very small number of dark pixels or continuously lit pixels exist on each screen. Also, a distorted image may remain on the screen for several seconds after the system has been turned off.
- Direct exposure to sunlight may damage the system's LCD screen. Be careful when using the system outdoors or near a window.
- When using the system in a cold environment, you may notice shadows on the graphics or the screen may appear darker than usual. This is not a malfunction, and the screen will return to normal when the temperature goes up.
- Some people may experience discomfort (such as eye strain, eye fatigue, or nausea) while watching 3D video images or playing stereoscopic 3D games on 3D televisions. If you experience such discomfort you should immediately discontinue use of your television until the discomfort subsides.
SCE recommends that all viewers take regular breaks while watching 3D video, or playing stereoscopic 3D games. The length and frequency of necessary breaks may vary from person to person - please take breaks that are long enough to allow any feelings of discomfort to subside. If symptoms persist, consult your doctor.
The vision of young children (especially those under six years old) is still under development. SCE recommends that you consult with a doctor (such as a pediatrician or eye doctor) before allowing a young child to watch 3D video images or play stereoscopic 3D games. Adults should supervise young children to ensure they follow the recommendations listed above. When using any 3D enabled device with your PlayStation®3 system you should read the instruction manual for that device and check www.us.playstation.com/support/3D for updated information.
- Be careful when carrying the product. If you do not have a good grip, the product may drop causing potential damage or injury.
- Do not place the product on surfaces that are unstable, tilted or subject to vibration.
- Do not place any objects on top of the product. Do not stand on the product.
- Do not throw or drop the product, or otherwise expose it to strong physical impact.
- Do not allow the product to come into contact with liquids.
- Follow the instructions below to help prevent the product exterior from deteriorating or becoming discolored.
 - Wipe with a soft, dry cloth.
 - Do not place any rubber or vinyl materials on the product exterior for an extended period of time.
 - Do not use solvents or other chemicals. Do not wipe with a chemically-treated cleaning cloth.

FCC and IC NOTICE

NOTE:

This equipment has been tested and found to comply with the limits for a Class B digital device, pursuant to Part 15 of the FCC rules.

These limits are designed to provide reasonable protection against harmful interference in a residential installation. This equipment generates, uses, and can radiate radio frequency energy and, if not installed and used in accordance with the instructions, may cause harmful interference to radio communications. However, there is no guarantee that interference will not occur in a particular installation. If this equipment does cause harmful interference to radio or television reception, which can be determined by turning the equipment off and on, the user is encouraged to try to correct the interference by one or more of the following measures:

- Reorient or relocate the receiving antenna.
- Increase the separation between the equipment and receiver.
- Connect the equipment into an outlet on a circuit different from that to which the receiver is connected.
- Consult the dealer or an experienced radio/TV technician for help.

You are cautioned that any changes or modifications not expressly approved by the party responsible for compliance could void the user's authority to operate the equipment.

For assistance with this product, visit www.us.playstation.com or call SCEA Consumer Services at 1-800-345-7669.

Declaration of Conformity

Trade Name : SONY
Model No. : CECH-ZED1U
Responsible Party : Sony Electronics Inc.
Address : 16530 Via Esprillo, San Diego, CA 92127 U.S.A.
Telephone No. : 858-942-2230



This device complies with Part 15 of the FCC Rules and Canadian ICES-003. Operation is subject to the following two conditions: (1) this device may not cause harmful interference, and (2) this device must accept any interference received, including interference that may cause undesired operation.

This Class B digital apparatus complies with Canadian ICES-003.

Lithium-ion batteries

The 3D glasses are equipped with a non-replaceable battery. Do not attempt to open the product or remove the battery. Consult your local waste management office for proper disposal.

Checking the version of the PS3™ system software

To use the 3D display, the PS3™ system software must be version 3.70 or later. You can check the system software version by selecting  (Settings)  (System Settings)  [System Information] on the XMB™ (XrossMediaBar) menu of the PS3™ system.

Unpacking

- 3D display (1)
- Stand (1)
- Neck (1)
- AC power cord (1)

Assembly

- 1 Insert the neck into the stand until you hear a click.
Check that the neck and stand face in the same direction, as shown in the illustration.
- 2 Securely anchor the neck in place by tightening the mounting screw on the bottom of the stand.
- 3 Insert the display into the neck until you hear a click.

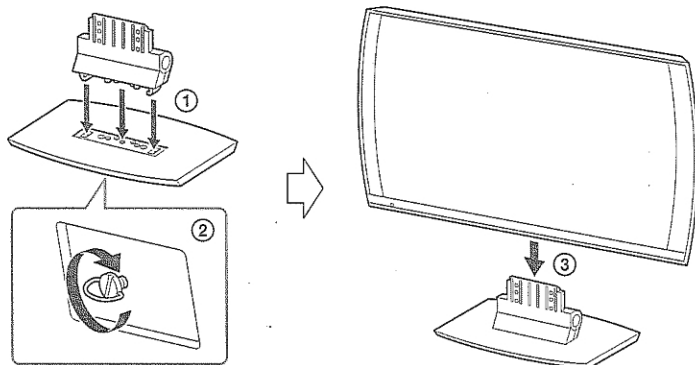

Hints

- Be careful not to pinch your hands or fingers when you assemble the stand and display.
- You can adjust the vertical tilt angle of the display by up to 10° from the vertical. Hold the stand down with one hand and move the upper part of the display with your other hand.
- At least two people must perform the steps for removing the display from the neck and stand. One person must hold the neck and stand securely on a flat surface and press the button on the hinge. At the same time, another person can lift the display upwards.

Rear

Press to detach display from neck and stand.

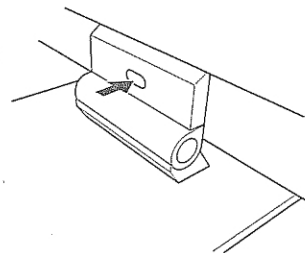

Using the 3D display

Front

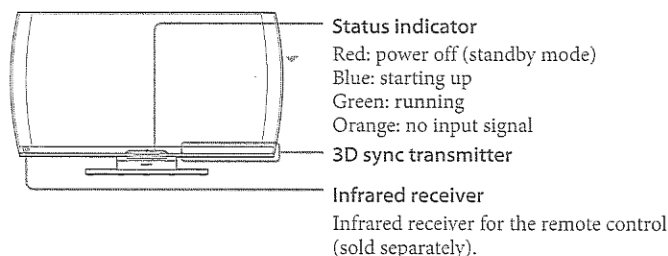

Rear

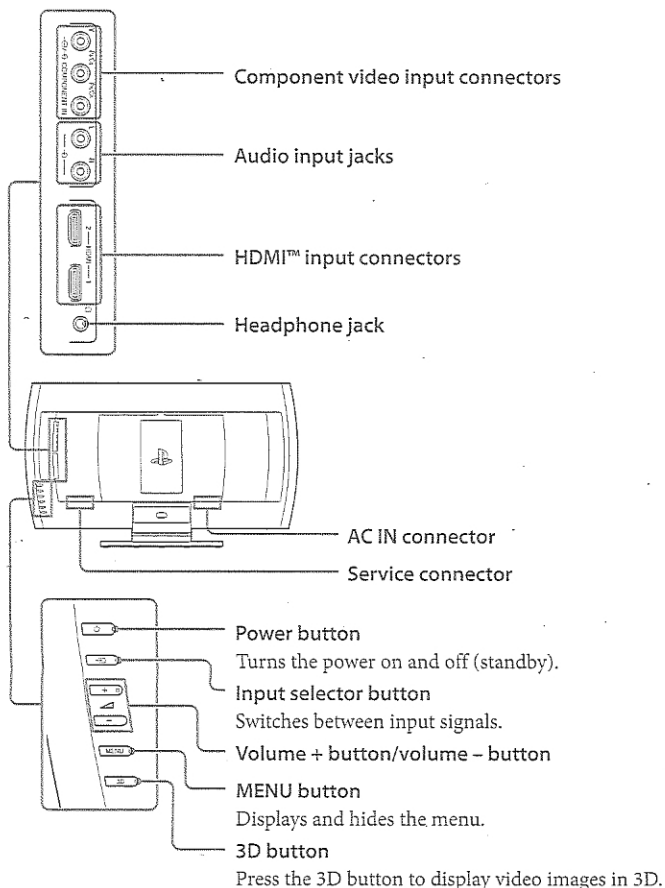

3D glasses

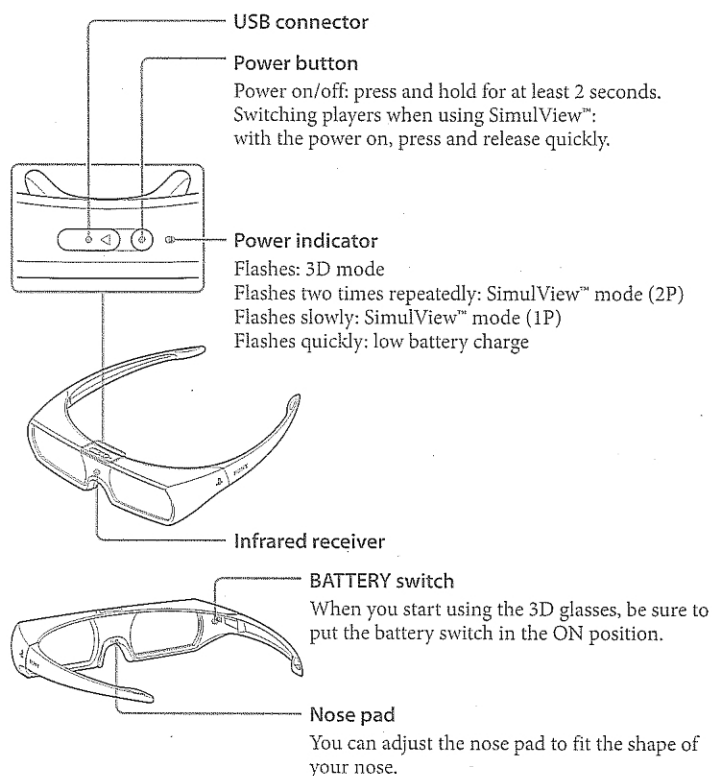

Hint

Be careful not to pinch yourself in the hinges of the 3D glasses.

Setting the video output on the PS3™ system

- 1 Go to (Settings) ⇒ (Display Settings).
- 2 Select [Video Output Settings].
- 3 Select [HDMI].
- 4 Select [Auto].
- 5 Verify the settings, select [Yes] and then press the button.
- 6 Set the display size to 24 inches.
- 7 Verify the settings, select [Yes] and then press the button.

Hint

When using this setting, connect the PS3™ system to the 3D display directly using an HDMI cable. If the display and the PS3™ system are connected via an AV amplifier or other device, this setting may not work correctly.

Navigating the menu

Picture	Backlight	Adjusts the brightness of the backlight
	Picture Mode	[Standard]: Provides a standard natural looking picture appropriate for home use [Dynamic]: Provides a bright picture with emphasis on sharpness and contrast [Cinema]: Provides a picture optimized for watching movies [Custom]: Applies custom picture settings
	Reset Current Mode	Resets all picture settings to default values
Screen*	Wide Mode	[Normal]: Displays the picture in its original size [Full]: Displays the picture in full-screen mode [PSP™ Zoom]: Displays the picture from a connected PSP™ (PlayStation®Portable) system in full-screen mode
	Overscan	Select [ON] when visual noise or a black frame can be seen around the edges of the screen.
Sound	Sound Mode	[Standard]: Provides a well-balanced, natural sound over the entire range [Dynamic]: Provides a clear sound with emphasis on high and low frequencies [Cinema]: Provides a sound with a feeling of you-are-there immediacy, just like being in a movie theater [Custom]: Applies custom sound settings
	Reset Current Mode	Resets all sound settings to default values
	Balance	Adjusts the volume balance between the left and right speakers.
3D	3D Format	Adjusts the settings to match the 3D format of the content being played when the 3D image is not displayed properly
Settings	HDMI Control	When you select [ON], the display and the connected HDMI equipment will be powered on and off simultaneously.
	Signal Information	Displays the resolution and frequency of the picture
	Quick Start	When you select [ON], the display will start more quickly when it is turned on. Note that this will increase power consumption when the display is in standby mode.
	Language	Sets the language displayed on the menu screens
	Restore Default Settings	Resets all settings to default values

* The [Screen] menu can be adjusted only when component video signal is input to the 3D display.

Hint

You can operate the 3D display using the Blu-ray Disc™ Remote Control CECH-ZRC1U (sold separately). When operating using the BD remote control, use the TV button, the MENU button, the RETURN button, the ENTER button and the directional buttons. For details on operation, see the instruction manual for the BD remote control.

Using SimulView™ mode

SimulView™ allows two players to view different screen images while playing the same game. To use this feature, the game must support SimulView™ and both players need 3D glasses.

Charging the 3D glasses

- 1 Open the USB connector cover. Connect a Type A - micro-B USB cable.
- 2 Connect the other end of the USB cable to a PS3™ system or other supported device.

The power indicator lights up during charging and turns off when charging is complete.

Hints

- If you start charging the 3D glasses while they are turned on, the power will turn off.
- The 3D glasses cannot be charged when the battery switch is in the OFF position.

Troubleshooting

The power to the display shuts off suddenly or has shut off unexpectedly.

⇒ The power goes off automatically when there is no incoming signal.

There are bright spots or dark spots on the screen.

⇒ Black (dark) pixels and continuously lit pixels may appear in certain locations on the LCD screen. The appearance of such dots (pixels) is a normal occurrence associated with LCD screens and is not a sign of a system malfunction.

3D or SimulView™ images are not displayed, or the image does not look like a 3D or SimulView™ image.

⇒ Check that the 3D glasses are turned on.

⇒ Check that the 3D glasses are charged.

⇒ The 3D glasses operate by receiving a constant infrared signal from the 3D sync transmitter. The glasses may not operate properly in the following cases.

- The 3D glasses do not face the 3D sync transmitter.
- There are objects blocking the path between the 3D glasses and the 3D sync transmitter.
- There are other infrared communication devices, lighting fixtures, space heaters, or similar equipment nearby.

⇒ Use the 3D glasses so that they are level with the display. If you are lying down or if your head is tilted, it may be difficult to experience the 3D effect and the color of the image may change.

⇒ If the display and the PS3™ system are connected via an AV amplifier or other device, 3D or SimulView™ images may not be displayed correctly. Connect the PS3™ system to the display directly using an HDMI cable, and then adjust the video output settings on the PS3™ system.

The 3D glasses are not receiving any power.

⇒ Check that the battery switch is in the ON position.

Specifications

3D display

Inputs and Outputs

HDMI input connectors × 2
Component video input connectors (Y/CB (PB)/CR (PR)) × 1 each
Audio input connectors × 2: 2 ch, pin jack
USB connector × 1: Type A, for service use only
Headphone output connector × 1: stereo mini jack

Speakers

Stereo 2 ch (full range, 3 W × 2, 28 mm × 28 mm, elliptical)
Subwoofer (5 W, 50 mm)
Load impedance: 8 Ω

Panel resolution

1920 × 1080

Effective screen size

23.5 inches

Power requirement

AC 100 V - 240 V (50/60 Hz)

Power consumption

60 W, 0.6 A - 0.26 A (in use),
0.2 W or less (in standby mode),
7 W or less (when the Quick Start feature is [ON])

Operating temperature

5°C - 35°C (41°F - 95°F)

Dimensions (w × h × d)

Approx. 650 × 391 × 207 mm (27.2 × 15.4 × 8.1 in.)
(including stand)

Weight

Approx. 5.7 kg (12.5 lbs) (including stand)

3D glasses

Battery type

Built-in, rechargeable lithium-ion battery

Battery voltage

DC 3.7 V

Battery capacity

70 mAh

Power consumption

5 V 100 mA

Dimensions (w × h × d)

Approx. 174 × 41 × 177 mm (6.9 × 1.6 × 7.0 in.) (in use),
approx. 174 × 41 × 60 mm (6.9 × 1.6 × 2.4 in.) (folded)

Weight

Approx. 47 g (1.7 oz)

Supplied HDMI cable and USB cable

HDMI cable

Company: SONY
Part No.: 1-839-588-11

USB cable

Company: SONY
Part No.: 1-839-578-11

Design and specifications are subject to change without notice.